

LEASE PLAN

Sheet of

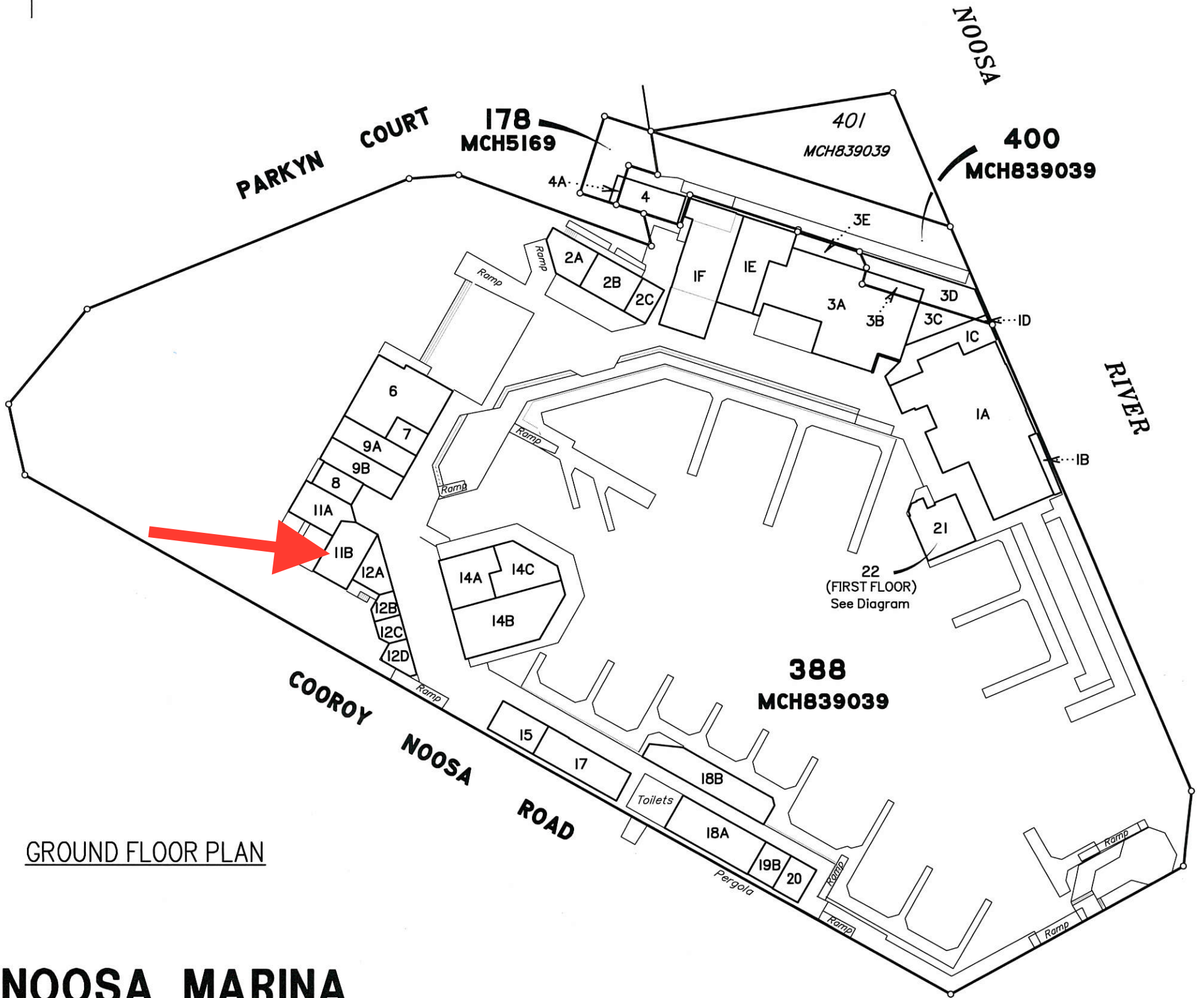
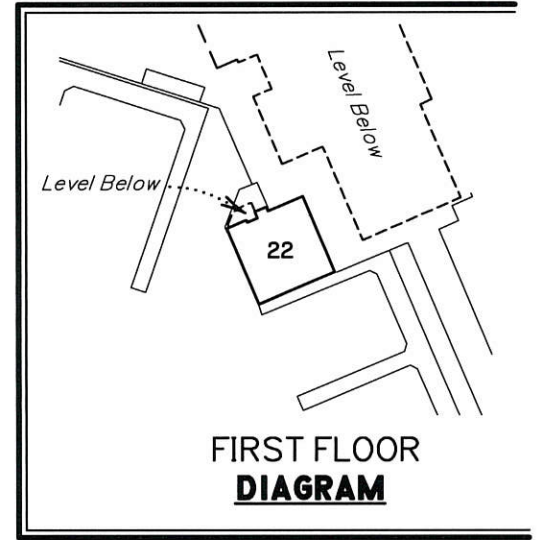

GROUND FLOOR PLAN

NOOSA MARINA

on Lot 178 on MCH5169 and
Lot 388 & 400 on MCH839039

JFP URBAN CONSULTANTS PTY. LTD., ACN 050 414 045
Cadastral Surveyor, certify that the details shown
on this sketch plan are correct.



Director *M. Aguilar*
Director *[Signature]*
Date 15/10/2015

SCALE 1:750

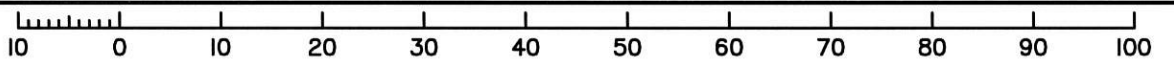

PARISH NOOSA

COUNTY MARCH

ORIGINAL -

LOCALITY TEWANTIN

MAP REF 9545 - 33413

MERIDIAN MCH839039

Local Authority Noosa Shire Council

PLAN FOR LEASE PURPOSES

MASTER SKETCH for the Building on

Lot 178 on MCH5169 and Lot 388 & 400 on MCH839039

JFP URBAN CONSULTANTS
BRISBANE - SUNSHINE COAST - CENTRAL QLD
SUNSHINE COAST
237-239 Bradman Avenue,
Maroochydore Qld 4558
P 07 5450 3900 W www.jfp.com.au

PLANNERS - URBAN DESIGNERS - SURVEYORS - ENGINEERS - LANDSCAPE ARCHITECTS

Examined JFP URBAN CONSULTANTS PTY LTD (ACN 050 414 045)
ENDORSED ACCREDITED SKETCH OK

Date: 14-10-2015

Drawing No. M1745-02F Master

Drawing File : M1745-02F Master.dwg